

# SURFACE MOUNT HIGH CURRENT POWER INDUCTORS /SMPI TYPE

## FEATURES

- ◆ Performance low resistance , high current rating.
- ◆ Low loss realized with low RDC.
- ◆ Low core loss.



## APPLICATIONS

- ◆ PDA / Notebook / Desktop, and server applications.
- ◆ DC/DC converters in distributed power systems.
- ◆ DC/DC converter for Field Programmable Gate Array(FPGA).

## ORDERING CODE

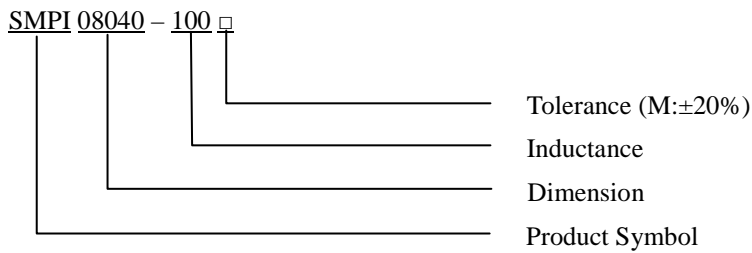

## DIMENSIONS UNIT: mm

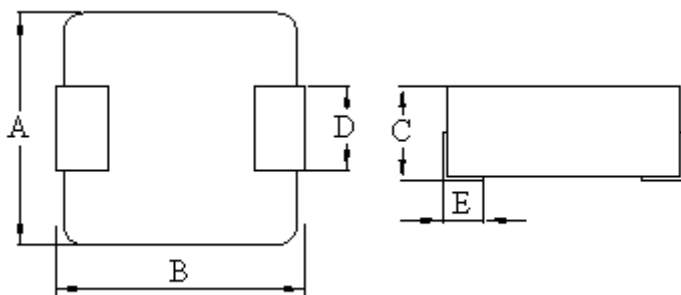

A	$8.0 \pm 0.3$	m/m
B	$8.6 \pm 0.6$	m/m
C	4.0 (MAX)	m/m
D	3.0 (REF)	m/m
E	1.8 (REF)	m/m

# SURFACE MOUNT HIGH CURRENT POWER INDUCTORS /SMPI TYPE

## ELECTRICAL CHARACTERISTICS FOR SMPI 08040

Part No.	Inductance (uH) @(0A)	Test Frequency	Heat Rating Current Irms(A)	Saturation Current Isat ( A ) drop30%	RDC (mΩ) MAX
SMPI08040-1R0M	1.0	100KHz/1V	13	18.0	6.5
SMPI08040-1R5M	1.5	100KHz/1V	12	16.0	8.0
SMPI08040-2R2M	2.2	100KHz/1V	10	15.0	9.0
SMPI08040-4R7M	4.7	100KHz/1V	8	11.5	19
SMPI08040-6R8M	6.8	100KHz/1V	6	10.0	27
SMPI08040-8R2M	8.2	100KHz/1V	5	8.0	48
SMPI08040-100M	10	100KHz/1V	5	7.0	48
SMPI08040-220M	22	100KHz/1V	4	6.0	118
SMPI08040-330M	33	100KHz/1V	3	4.0	168
SMPI08040-470M	47	100KHz/1V	2	3.5	200

Notes:

- 1) You require another part number please contact with us.
- 2) Inductance Tolerance  $\pm 20\%$  ; Frequency Test : 100KHz/1.0v
- 3) All test data is referenced to 25°C ambient.
- 4) Irms : DC current (A) that will cause an approximate  $\Delta T$  of 40°C
- 5) Isat : DC current (A) that will cause  $L_o$  to drop approximately 30%
- 6) We can design according to customer's request.



**CORE MASTER ENTERPRISE CO., LTD.**

<http://www.coremaster.com.tw>